

# Presto™ Remote Touchscreen Installation Instructions

## Regulatory Compliance

### Safety

This device has been tested and found to be in compliance with the requirements set forth in UL 916, Energy Management Equipment, and is listed by Underwriters Laboratories, Inc., for installations in the United States.

This device has been tested and found to be in compliance with the requirements set forth in C22.2, No. 205-M1983, Signal Equipment, and is Certified by Underwriters Laboratories, Inc., for installations in Canada.

---

### Disclaimer

Presto™ is a trademark of Novar Controls Corporation.

The material in this manual is for information purposes only. The contents and the product it describes are subject to change without notice. Novar Controls Corporation makes no representations or warranties with respect to this manual.

In no event shall Novar Controls Corporation be liable for technical or editorial omissions or mistakes in this manual, nor shall it be liable for any damages, direct or incidental, arising out of or related to the use of this manual.

---

Copyright © 2004 by Novar Controls Corporation. All rights reserved.

No part of this manual may be reproduced in any form or by any means without prior written permission from Novar Controls Corporation.

Novar Controls Corporation  
6060 Rockside Woods Blvd., Cleveland, OH 44131  
Tel.: 800.348.1235 www.novarcontrols.com

## Description

Novar Controls Corporation's Presto™ Energy Infosystem is a comprehensive, totally integrated, automation system designed to meet a restaurant's control and facility information needs. It combines state-of-the art microprocessor technology and software development techniques with the most advanced automation and information management concepts to bridge the gap between building automation and management information systems.

The Presto remote touchscreen display allows restaurant management and service personnel to:

- Navigate through the system.
- Monitor and adjust various critical temperatures and operating parameters for indoor/outdoor lighting, heating, air-conditioning, refrigeration systems, and kitchen equipment.
- Initiate a timed override.
- Make temporary or permanent schedule changes.
- Change temperature setpoints.
- Obtain operational and diagnostic information to prevent downtime and optimize utility usage.
- Initiate a call for service.
- Acknowledge alarms. (Presto automatically announces and displays alarms, locally and remotely, to a service company or corporate headquarters.)

This document provides instructions for mounting the installation bracket, wiring the module, installing the electronics assembly, and checking the installation.

---

## Specifications

### Agency Approvals

Listed device:	CUL/UL E90949
Standards used:	UL 916, Energy Management Equipment CSA C22.2, No. 205-M1983, Signal Equipment

---

### Power Requirements

Voltage & Consumption:	24 VAC, 10 VA, Class 2 or 24 VDC, 250 mA, Class 2
------------------------	--

---

### Operating Environment

Temperature:	32° to 158°F (0° to 70°C)
Humidity:	0–95% Relative, noncondensing

---

### Physical Dimensions

Height:	7 inches
Width:	9 inches
Depth:	3 inches
Weight:	2 lb 1 oz

---

## Precautions

Take the following precautions during installation:

- Observe all national and local electrical codes.
  - Turn off all power before installing and wiring this module.
- 

## Mounting the Bracket

### Preparing the Mounting Surface

---

**NOTE!** The last page of these instructions contains a template that can be removed and used to mark the mounting surface.

---

Use the following procedure to prepare the mounting surface for the bracket that will hold the remote touchscreen.

<b>Step</b>	<b>Procedure</b>
1	Position the template supplied with these instructions (see last page) against the mounting surface <i>with the arrow pointing upward</i> .
2	Mark the mounting surface to show the locations of the: <ul style="list-style-type: none"><li>■ Four mounting holes.</li><li>■ Area to be cut out (indicated on the template by a large “X” and the word “Cutout”).</li></ul>
3	Cut out the area marked on the mounting surface (see Step 2).
4	Drill a ¼-inch hole in each of the mounting hole locations marked on the mounting surface (see Step 2).

---

### Positioning and Fastening the Bracket in Place

The mounting bracket consists of the section that will sit flat against the mounting surface and a section on each of the four sides of the cutout area that has been bent back to be inserted into the cutout area. The upper and lower sections that are bent back contain the pieces that will be used as the backing strips (see Figure 1) when the bracket is mounted.

Use the following procedure and refer to Figure 1, as necessary, to mount the bracket.

Step	Procedure
1	<p>Fold the backing strips (see Figure 1) back and forth until they break away from the bracket.</p> <hr/> <p><b>NOTE!</b> Each backing strip is attached to one side of the bracket with a plastic tie to prevent it from getting lost once it is broken away from the bracket. Do not remove these ties.</p> <hr/>
2	<p>Position the bracket against the front of the mounting surface, <b>arrow pointing up</b>, so that the mounting holes align with the holes drilled in the surface.</p>
3	<p>Push the bracket gently into the cutout area.</p>
4	<p>Position the backing strips flat against the <i>back</i> (or inside) of the mounting surface, aligning the mounting holes on the strips with those in the surface and the bracket.</p> <ul style="list-style-type: none"> <li>■ The heads of the threaded screw holes on the strips should be on the outside of the strip, away from the mounting surface.</li> </ul>
5	<p>Insert the 1-inch mounting screws (supplied) through the bracket, mounting surface, and backing strip screw heads and partially tighten.</p>
6	<p>Adjust the bracket to make sure it is level and finish tightening the screws to secure the bracket to the mounting surface.</p>

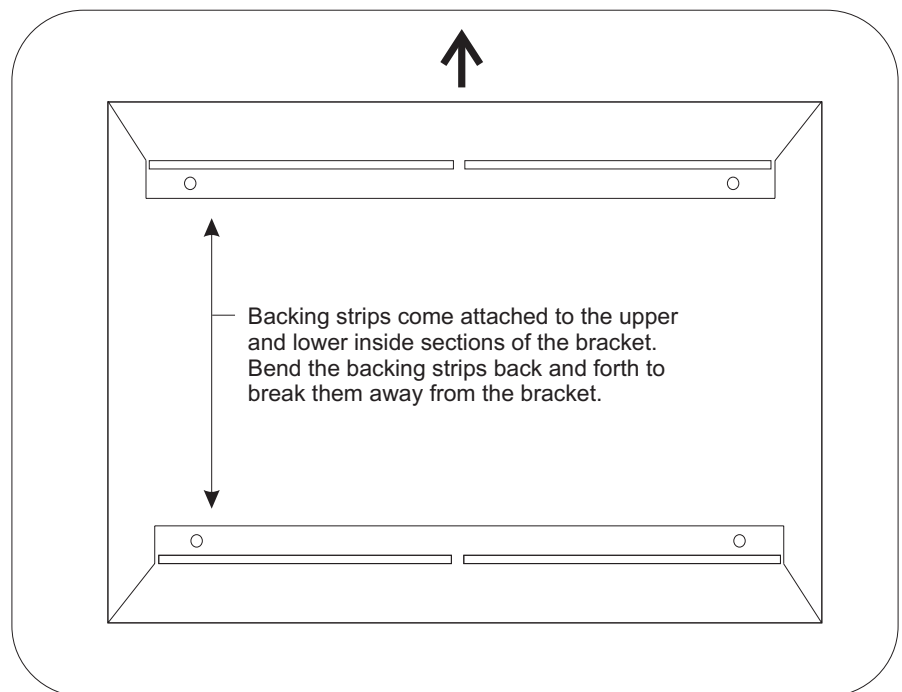

**Figure 1.** Presto remote touchscreen bracket with backing strips still attached

## Wiring the Remote Touchscreen

A four-conductor cable (Belden 9155, Novar Controls WIR-1020, or equivalent) should be used to make the wiring connections. The maximum cable length acceptable is 500 feet.

The remote touchscreen's terminal strip is located on the back of the electronics assembly (see Figure 2).

---

**NOTE!** The Ethernet connection at the top left corner on the back of the electronics assembly is not currently functional.

---

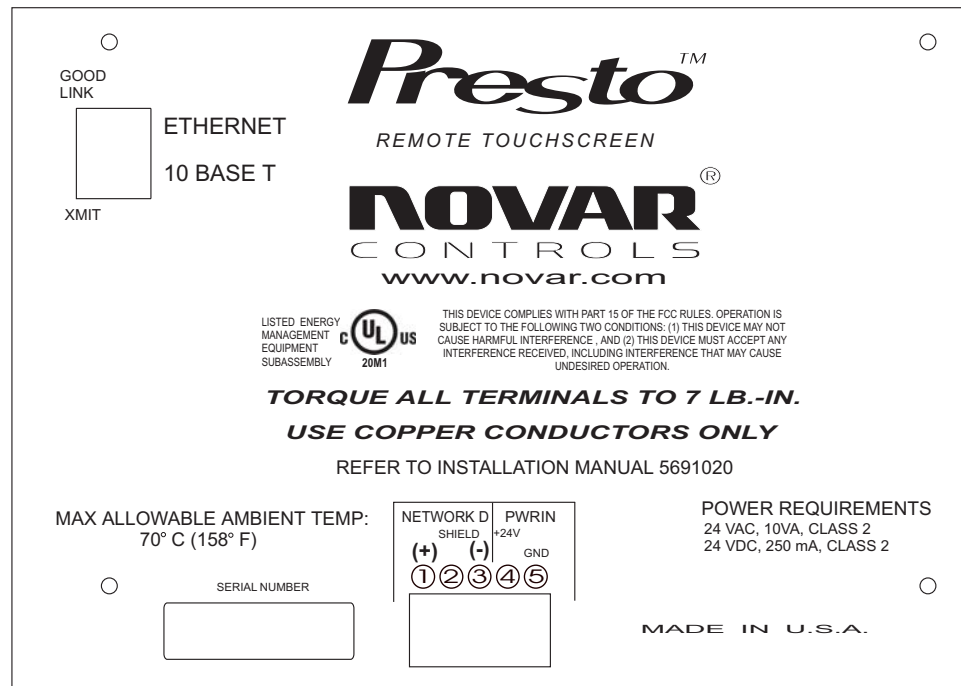

**Figure 2.** Rear view of the remote touchscreen electronics assembly

Use the following procedure to connect the wiring between the remote touchscreen and the main Presto module.

Step	Procedure
1	Turn off all power to the main Presto module and the remote touchscreen before making any wiring connections.
2	Connect the wires to the remote touchscreen terminal strip and the main Presto module as indicated in Table 1. <ul style="list-style-type: none"> <li>■ If necessary, the remote touchscreen’s terminal strip can be removed to facilitate the wiring.</li> </ul>
3	Insert the wiring into the white plastic wire retention clamp on either side of the mounting bracket and twist the clamp to close it. <ul style="list-style-type: none"> <li>■ This will secure the wiring and prevent it from getting lost inside the mounting surface.</li> </ul>
4	Check all wiring connections to make sure they are correct and secure.

<b>Table 1. Presto Remote Touchscreen Wiring Connections</b>		
WIRE	CONNECTS TO THE REMOTE TOUCHSCREEN AT	CONNECTS TO THE MAIN PRESTO MODULE AT
Red	Terminal 1 (+)	Terminal 73 (+)
Shield	Terminal 2 (Shield)	Terminal 72 (Shield)
Black	Terminal 3 (-)	Terminal 71 (-)
White	Terminal 4 (+24)	Terminal 55 (+24V)
Green	Terminal 5 (GND)	Terminal 74 (GND)

## Installing the Electronics Assembly

The electronics assembly consists of the metal case that encloses the circuit boards and the touchscreen.

Once the wiring has been connected, the electronics assembly can be mounted in the bracket using the following procedure.

Step	Procedure
1	Position the electronics assembly over the mounting bracket and gently push it into the cutout area.
2	Align the holes on the electronics assembly with the mounting holes on the sections of the bracket that extend out from the mounting surface.
3	Insert and tighten the ¼-inch mounting screws (supplied) to secure the assembly to the bracket.

## Checking the Installation

Once the bracket has been mounted, the wiring has been connected, and the electronics have been installed, the following items should be checked to ensure proper operation.

- Check the power and status light-emitting diode (LED) on the front of the touchscreen. It should be flashing if proper communication is taking place.
- Touch the touchscreen to make sure that the back light comes on when contact is made.
- Access some of the screens on the remote touchscreen, change some of the settings, and monitor the equipment for proper response.

Refer to the Novar Controls *Presto Energy Infosystem User's Guide* (Doc. No. 569101000) for operating instructions.

---

## Model and Part Numbers

Use the part numbers shown in Table 2 to order the necessary Novar Controls parts.

<b>Table 2. Novar Controls Part Numbers</b>		
<b>PRODUCT</b>	<b>MODEL NO.</b>	<b>PART NO.</b>
Presto Energy Infosystem	—	75201220 0
Presto Remote Touchscreen	—	75210000 0
Four-conductor cable (Belden 9155 equivalent)	WIR-102 0	70900200 0

---



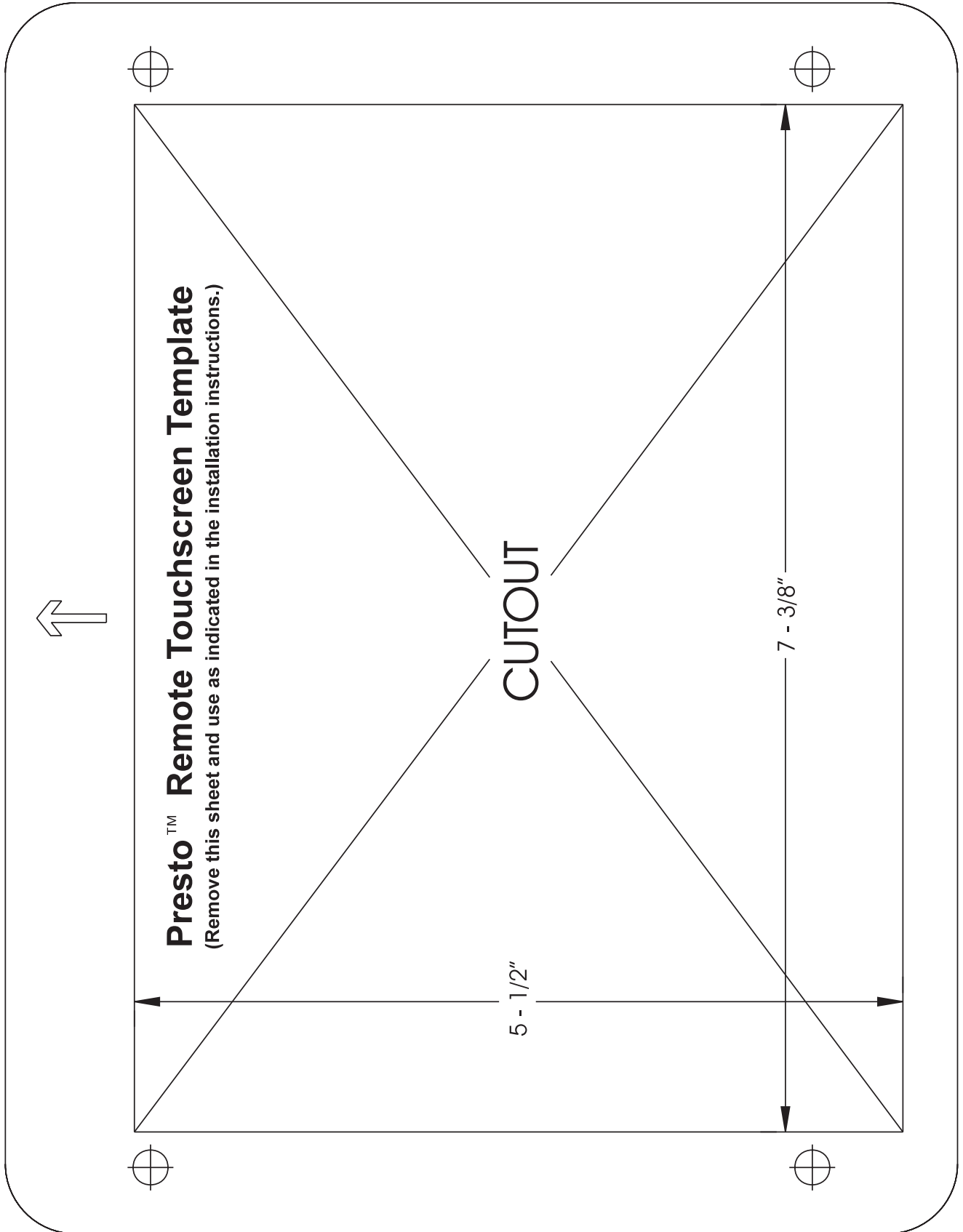

This page intentionally left blank.